

INFORMATION
DOSSIER



Anant**mani**
FOCUSSED ON THE INFINITE



INDEX



Ground Level Plan



Podium Level Plan



Banquet Plan



Floor Plans



Specifications



Area Statement

GROUND LEVEL PLAN

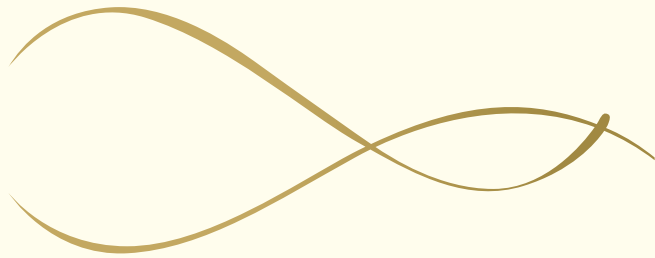

LEGEND:

- 1. ENTRANCE COURT
- 2. DROP OFF
- 3. FOYER GARDEN
- 4. CRICKET NET
- 5. DESIGNER LAWN
- 6. WATER WALL
- 7. BADMINTON COURT
- 8. DOUBLE HEIGHT ENTRANCE LOBBY
- 9. PARKING UNDER TRELLIS
- 10. GROUND COVER PARKING
- 11. MECHANICAL CAR PARKING UNDER TRELLIS
- 12. DRIVERS' REST AREA
- 13. BANQUET ENTRANCE LOBBY
- 14. BANQUET SERVICES
- 15. SERVICES



PODIUM LEVEL PLAN



LEGEND:

- 1. PODIUM GARDEN
- 2. HALF BASKETBALL COURT
- 3. PEDESTRIAN RAMP
- 4. KIDS PLAY AREA
- 5. AMPHITHEATRE
- 6. SWIMMING POOL
- 7. KIDS POOL
- 8. OUTDOOR JACUZZI
- 9. FOUNTAIN POOL
- 10. POOL DECK
- 11. CHANGING ROOM, SPA, STEAM, SAUNA (GENTS)
- 12. CHANGING ROOM, SPA, STEAM, SAUNA (LADIES)
- 13. DOUBLE LEVEL GYMNASIUM
- 14. INDOOR GAMES ROOM
- 15. CHILDREN PLAY AREA
- 16. BARBEQUE
- 17. GRASS LAWN
- 18. DOUBLE HEIGHT ENTRANCE LOBBY
- 19. APARTMENT AREA
- 20. PRIVATE GARDEN FOR 1ST FLOOR APARTMENT
- 21. YOGA AND MEDITATION DECK
- 22. BANQUET PLAZA
- 23. CASCADING WATER WALL



BANQUET FIRST FLOOR PLAN



BANQUET TERRACE PLAN

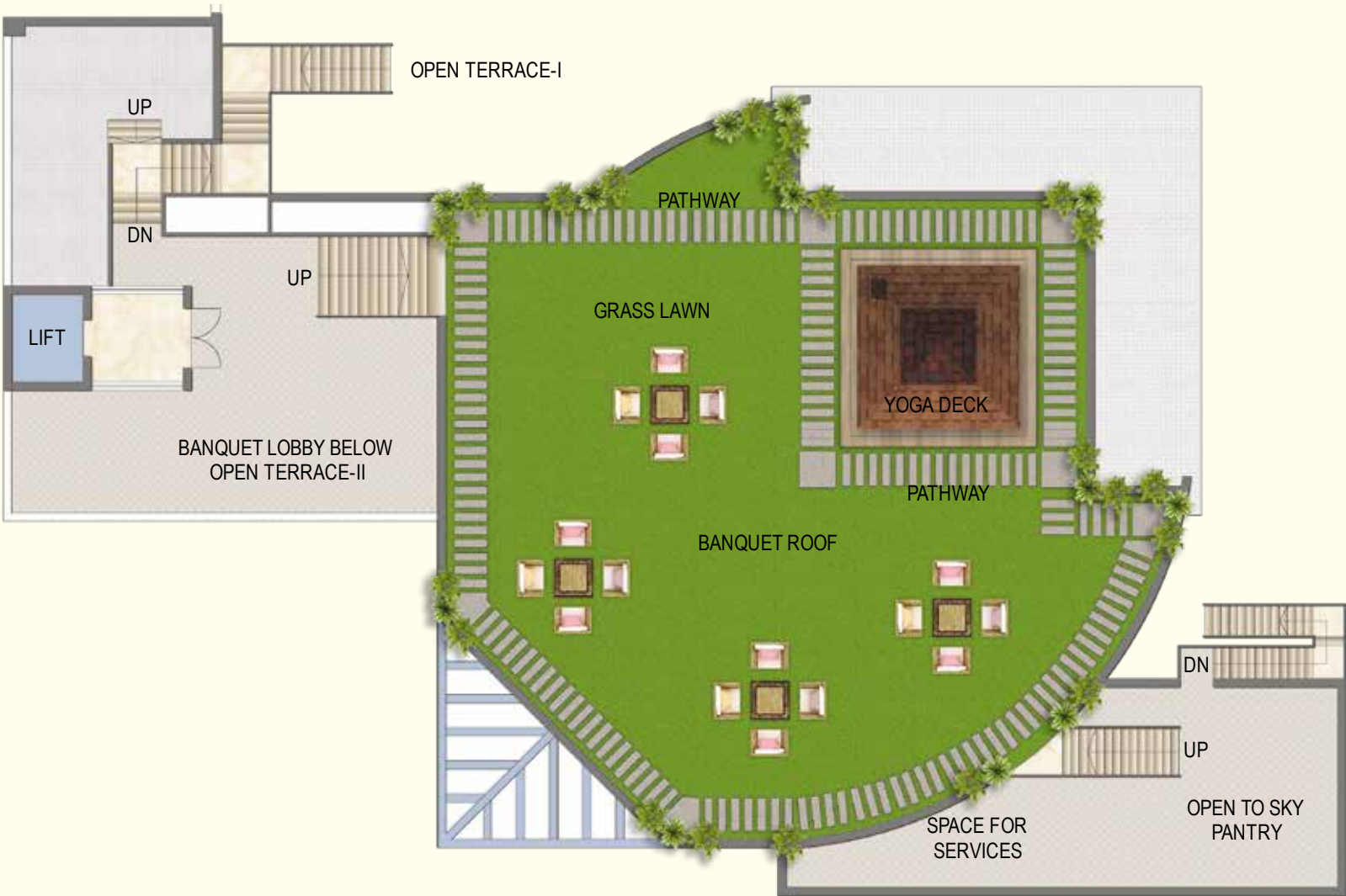

BANQUET - SCHEMATIC

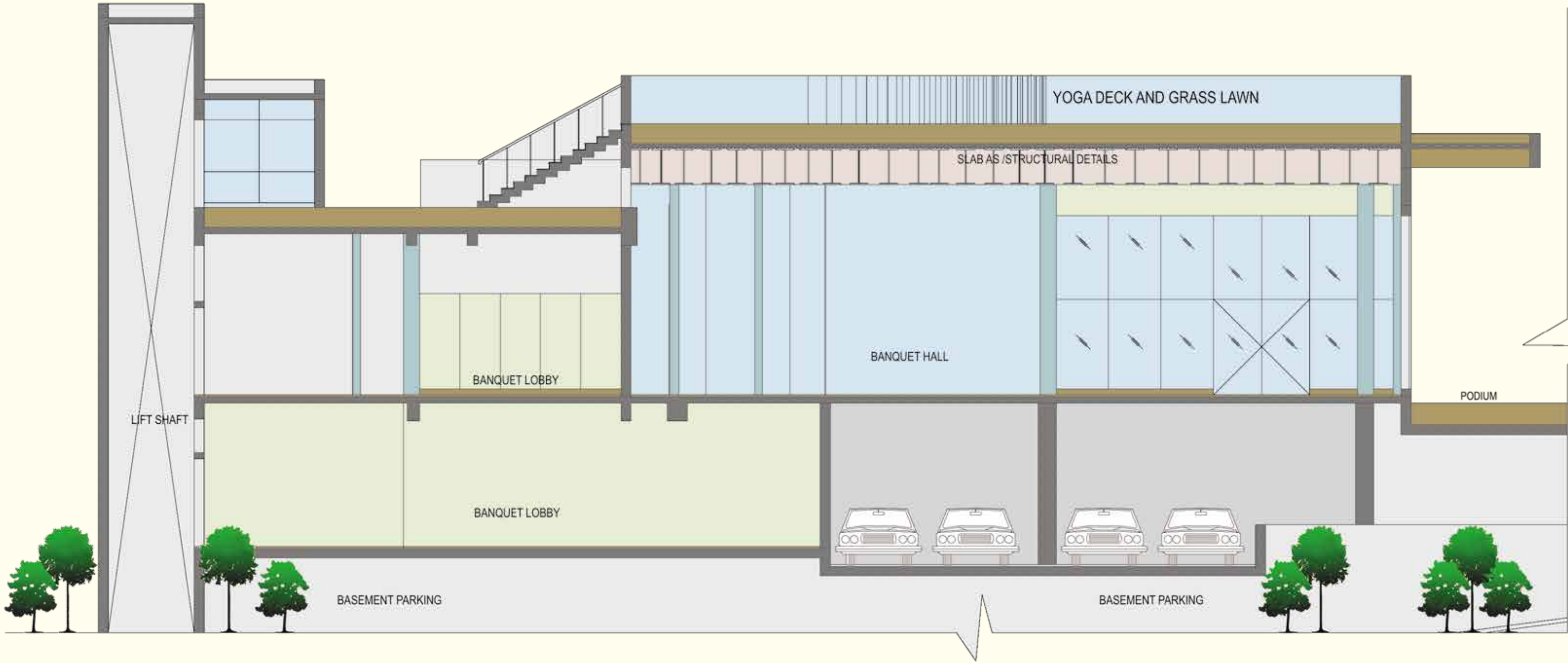

FLOOR PLAN - SADASHIVA

1ST FLOOR

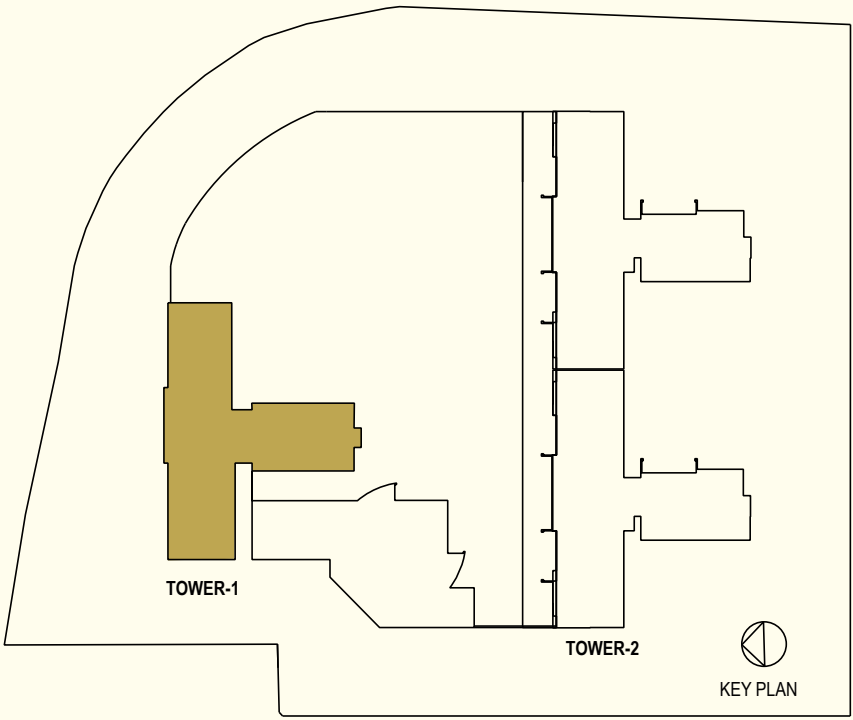

FLOOR PLAN - SADASHIVA

2ND FLOOR



FLAT TYPE - A		
SL. NO.	SPACE MARKING	ROOM DIMENSION (IN FPS)
1	PUJA	4'-10" X 5'-6"
2	MASTER BEDROOM	17'-0" X 12'-0"
3	MASTER TOILET	8'-0" X 6'-8"
4	DRESS	5'-8" X 7'-3"
5	BEDROOM-1	14'-0" X 11'-10"
6	TOILET-1	8'-10" X 5'-6"
7	BEDROOM-2	11'-10" X 11'-10"
8	TOILET-2	9'-2" X 7'-3"
9	BEDROOM-3	14'-0" X 11'-10"
10	DINING	14'-6" X 11'-4"
11	KITCHEN	12'-7" X 7'-10"
12	UTILITY / WASH	3'-6" X 6'-9"
13	DRAWING ROOM	19'-0" X 17'-3"
14	BALCONY	4'-0" X 12'-0"

FLAT TYPE - B		
SL. NO.	SPACE MARKING	ROOM DIMENSION (IN FPS)
1	PUJA	5'-0" X 8'-0"
2	MASTER BEDROOM	13'-8" X 11'-3"
3	MASTER TOILET	8'-10" X 5'-5"
4	DRESS	4'-10" X 6'-0"
5	BEDROOM-1	14'-0" X 9'-7"
6	TOILET-1	9'-9" X 5'-7"
7	BEDROOM-2	11'-10" X 11'-10"
8	BEDROOM-3	14'-0" X 11'-10"
9	TOILET-2	9'-2" X 7'-3"
10	DINING	16'-6" X 11'-4"
11	KITCHEN	12'-2" X 7'-10"
12	UTILITY / WASH	3'-6" X 6'-9"
13	DRAWING ROOM	19'-0" X 17'-3"
14	POWDER TOILET	4'-0" X 5'-7"
15	BALCONY	4'-0" X 12'-0"

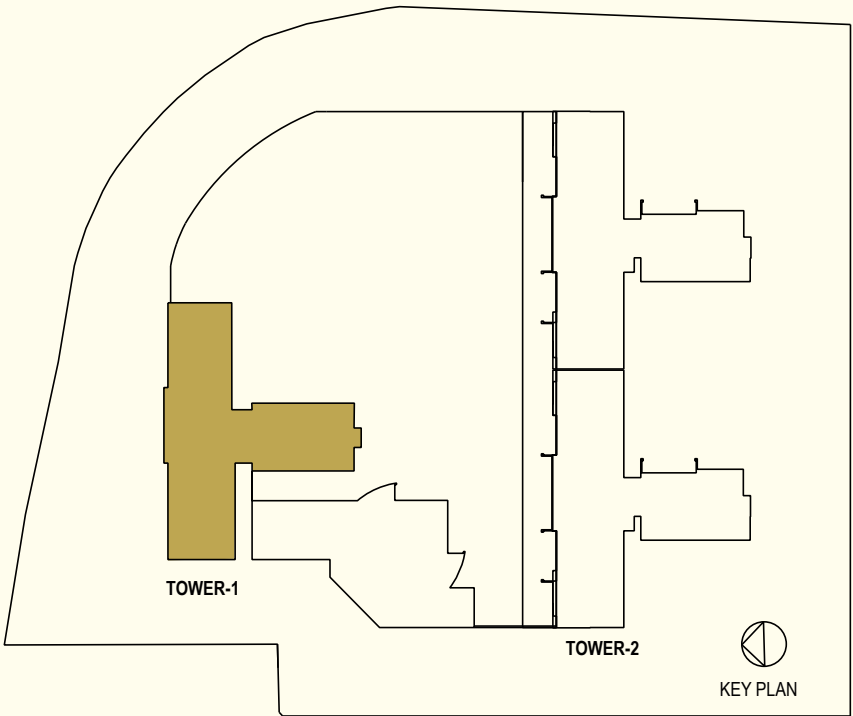

FLOOR PLAN - MAHADEVA

1ST FLOOR

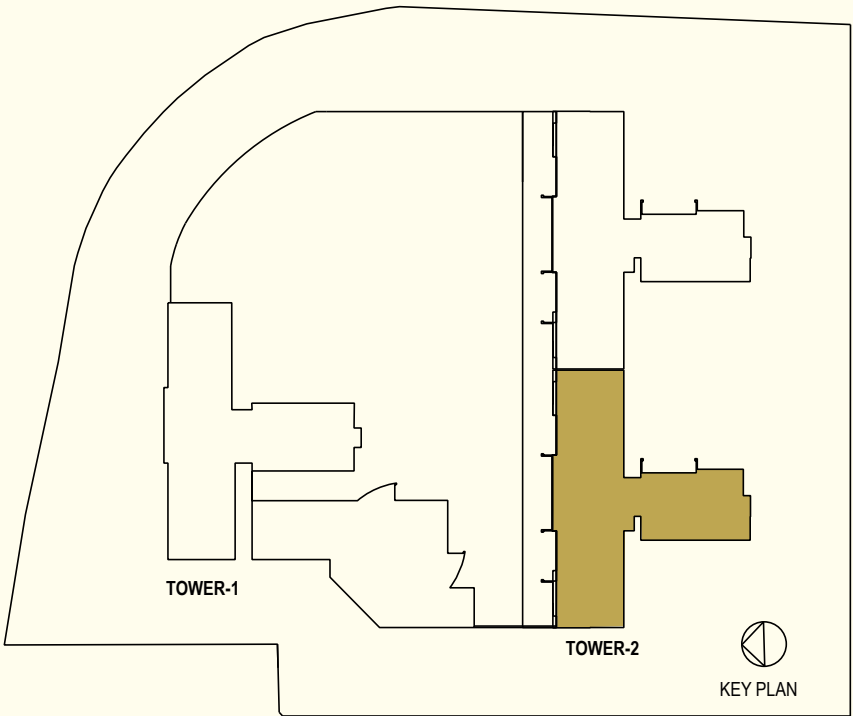
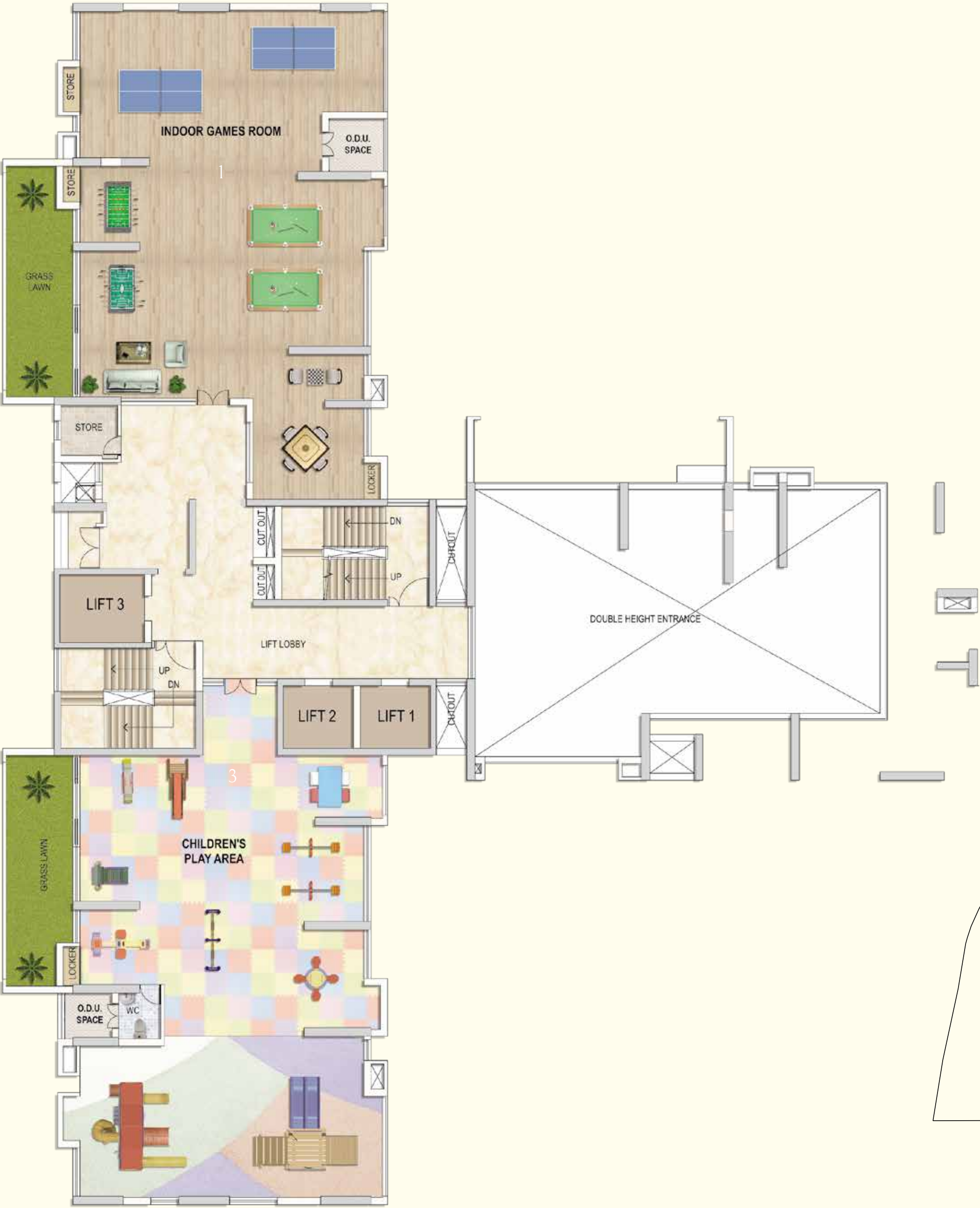

FLOOR PLAN - MAHADEVA

2ND FLOOR



FLAT TYPE - A		
SL. NO.	SPACE MARKING	ROOM DIMENSION (IN FPS)
1	PUJA	4'-10" X 5'-6"
2	MASTER BEDROOM	17'-0" X 12'-0"
3	MASTER TOILET	8'-0" X 6'-8"
4	DRESS	5'-8" X 7'-3"
5	BEDROOM-1	14'-0" X 11'-10"
6	TOILET-1	8'-10" X 5'-6"
7	BEDROOM-2	11'-10" X 11'-10"
8	TOILET-2	9'-2" X 7'-3"
9	BEDROOM-3	14'-0" X 11'-10"
10	DINING	14'-6" X 11'-4"
11	KITCHEN	12'-7" X 7'-10"
12	UTILITY / WASH	3'-6" X 6'-9"
13	DRAWING ROOM	19'-0" X 17'-3"
14	BALCONY	4'-0" X 12'-0"

FLAT TYPE - B		
SL. NO.	SPACE MARKING	ROOM DIMENSION (IN FPS)
1	PUJA	5'-0" X 8'-0"
2	MASTER BEDROOM	13'-8" X 11'-3"
3	MASTER TOILET	8'-10" X 5'-5"
4	DRESS	4'-10" X 6'-0"
5	BEDROOM-1	14'-0" X 9'-7"
6	TOILET-1	9'-9" X 5'-7"
7	BEDROOM-2	11'-10" X 11'-10"
8	BEDROOM-3	14'-0" X 11'-10"
9	TOILET-2	9'-2" X 7'-3"
10	DINING	16'-6" X 11'-4"
11	KITCHEN	12'-2" X 7'-10"
12	UTILITY / WASH	3'-6" X 6'-9"
13	DRAWING ROOM	19'-0" X 17'-3"
14	POWDER TOILET	4'-0" X 5'-7"
15	BALCONY	4'-0" X 12'-0"

FLAT TYPE - C		
SL. NO.	SPACE MARKING	ROOM DIMENSION (IN FPS)
1	PUJA	6'-6" X 5'-0"
2	MASTER BEDROOM	16'-3" X 14'-0"
3	MASTER TOILET	9'-9" X 5'-10"
4	DRESS	6'-0" X 5'-10"
5	BEDROOM-1	11'-3" X 14'-0"
6	TOILET-1	6'-2" X 9'-6"
7	BEDROOM-2	12'-0" X 14'-0"
8	TOILET-2	5'-4" X 8'-9"
9	BEDROOM-3	12'-0" X 14'-0"
10	TOILET-3	5'-2" X 8'-9"
11	DINING	11'-4" X 14'-5"
12	KITCHEN	8'-0" X 12'-2"
13	UTILITY / WASH	3'-6" X 6'-9"
14	DRAWING ROOM	17'-0" X 18'-0"
15	BALCONY	4'-0" X 12'-0"

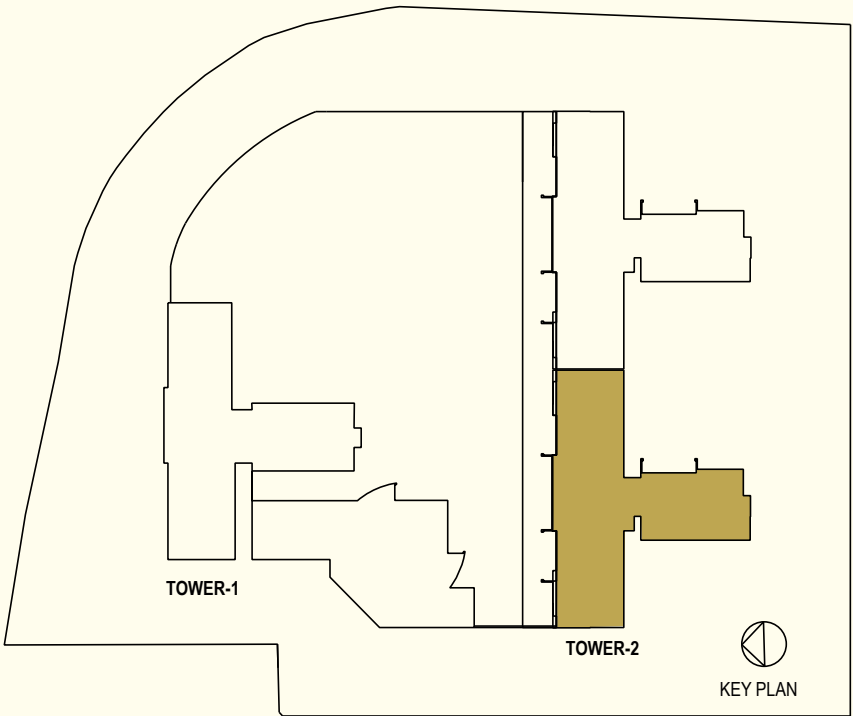

TYPICAL FLOOR PLAN

3RD, 6TH, 9TH, 12TH, 15TH, 18TH, 21ST, 24TH & 27TH FLOORS



FLAT TYPE - A		
SL. NO.	SPACE MARKING	ROOM DIMENSION (IN FPS)
1	PUJA	4'-10" X 5'-6"
2	MASTER BEDROOM	17'-0" X 12'-0"
3	MASTER TOILET	8'-0" X 6'-8"
4	DRESS	5'-8" X 7'-3"
5	BEDROOM-1	14'-0" X 11'-10"
6	TOILET-1	8'-10" X 5'-6"
7	BEDROOM-2	11'-10" X 11'-10"
8	TOILET-2	9'-2" X 7'-3"
9	BEDROOM-3	14'-0" X 11'-10"
10	DINING	14'-6" X 11'-4"
11	KITCHEN	12'-7" X 7'-10"
12	UTILITY / WASH	3'-6" X 6'-9"
13	DRAWING ROOM	19'-0" X 17'-3"
14	BALCONY	4'-0" X 12'-0"
15	OPEN TERRACE AREA - 168 SQ.FT.	

FLAT TYPE - B		
SL. NO.	SPACE MARKING	ROOM DIMENSION (IN FPS)
1	PUJA	5'-0" X 8'-0"
2	MASTER BEDROOM	13'-8" X 11'-3"
3	MASTER TOILET	8'-10" X 5'-5"
4	DRESS	4'-10" X 6'-0"
5	BEDROOM-1	14'-0" X 9'-7"
6	TOILET-1	9'-9" X 5'-7"
7	BEDROOM-2	11'-10" X 11'-10"
8	BEDROOM-3	14'-0" X 11'-10"
9	TOILET-2	9'-2" X 7'-3"
10	DINING	16'-6" X 11'-4"
11	KITCHEN	12'-2" X 7'-10"
12	UTILITY / WASH	3'-6" X 6'-9"
13	DRAWING ROOM	19'-0" X 17'-3"
14	POWDER TOILET	4'-0" X 5'-7"
15	BALCONY	4'-0" X 12'-0"
16	OPEN TERRACE AREA - 145 SQ.FT.	

FLAT TYPE - C		
SL. NO.	SPACE MARKING	ROOM DIMENSION (IN FPS)
1	PUJA	6'-6" X 5'-0"
2	MASTER BEDROOM	16'-3" X 14'-0"
3	MASTER TOILET	9'-9" X 5'-10"
4	DRESS	6'-0" X 5'-10"
5	BEDROOM-1	11'-3" X 14'-0"
6	TOILET-1	6'-2" X 9'-6"
7	BEDROOM-2	12'-0" X 14'-0"
8	TOILET-2	5'-4" X 8'-9"
9	BEDROOM-3	12'-0" X 14'-0"
10	TOILET-3	5'-2" X 8'-9"
11	DINING	11'-4" X 14'-5"
12	KITCHEN	8'-0" X 12'-2"
13	UTILITY / WASH	3'-6" X 6'-9"
14	DRAWING ROOM	17'-0" X 18'-0"
15	BALCONY	4'-0" X 12'-0"
16	OPEN TERRACE AREA - 115 SQ.FT.	

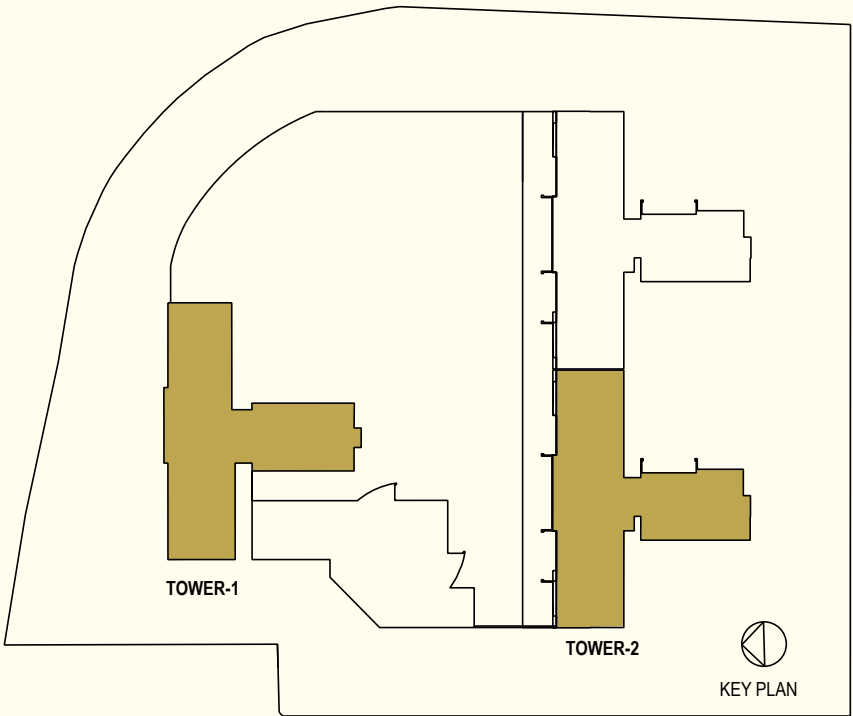

TYPICAL FLOOR PLAN

4TH, 7TH, 10TH, 13TH, 16TH, 19TH, 22ND, 25TH & 28TH FLOORS



FLAT TYPE - A		
SL. NO.	SPACE MARKING	ROOM DIMENSION (IN FPS)
1	PUJA	4'-10" X 5'-6"
2	MASTER BEDROOM	17'-0" X 12'-0"
3	MASTER TOILET	8'-0" X 6'-8"
4	DRESS	5'-8" X 7'-3"
5	BEDROOM-1	14'-0" X 11'-10"
6	TOILET-1	8'-10" X 5'-6"
7	BEDROOM-2	11'-10" X 11'-10"
8	TOILET-2	9'-2" X 7'-3"
9	BEDROOM-3	14'-0" X 11'-10"
10	DINING	14'-6" X 11'-4"
11	KITCHEN	12'-7" X 7'-10"
12	UTILITY / WASH	3'-6" X 6'-9"
13	DRAWING ROOM	19'-0" X 17'-3"
14	BALCONY	4'-0" X 12'-0"
15	OPEN TERRACE AREA - 107 SQ.FT.	

FLAT TYPE - B		
SL. NO.	SPACE MARKING	ROOM DIMENSION (IN FPS)
1	PUJA	5'-0" X 8'-0"
2	MASTER BEDROOM	13'-8" X 11'-3"
3	MASTER TOILET	8'-10" X 5'-5"
4	DRESS	4'-10" X 6'-0"
5	BEDROOM-1	14'-0" X 9'-7"
6	TOILET-1	9'-9" X 5'-7"
7	BEDROOM-2	11'-10" X 11'-10"
8	BEDROOM-3	14'-0" X 11'-10"
9	TOILET-2	9'-2" X 7'-3"
10	DINING	16'-6" X 11'-4"
11	KITCHEN	12'-2" X 7'-10"
12	UTILITY / WASH	3'-6" X 6'-9"
13	DRAWING ROOM	19'-0" X 17'-3"
14	POWDER TOILET	4'-0" X 5'-7"
15	BALCONY	4'-0" X 12'-0"
16	OPEN TERRACE AREA - 107 SQ.FT.	

FLAT TYPE - C		
SL. NO.	SPACE MARKING	ROOM DIMENSION (IN FPS)
1	PUJA	6'-6" X 5'-0"
2	MASTER BEDROOM	16'-3" X 14'-0"
3	MASTER TOILET	9'-9" X 5'-10"
4	DRESS	6'-0" X 5'-10"
5	BEDROOM-1	11'-3" X 14'-0"
6	TOILET-1	6'-2" X 9'-6"
7	BEDROOM-2	12'-0" X 14'-0"
8	TOILET-2	5'-4" X 8'-9"
9	BEDROOM-3	12'-0" X 14'-0"
10	TOILET-3	5'-2" X 8'-9"
11	DINING	11'-4" X 14'-5"
12	KITCHEN	8'-0" X 12'-2"
13	UTILITY / WASH	3'-6" X 6'-9"
14	DRAWING ROOM	17'-0" X 18'-0"
15	BALCONY	4'-0" X 12'-0"
16	OPEN TERRACE AREA - 165 SQ.FT.	

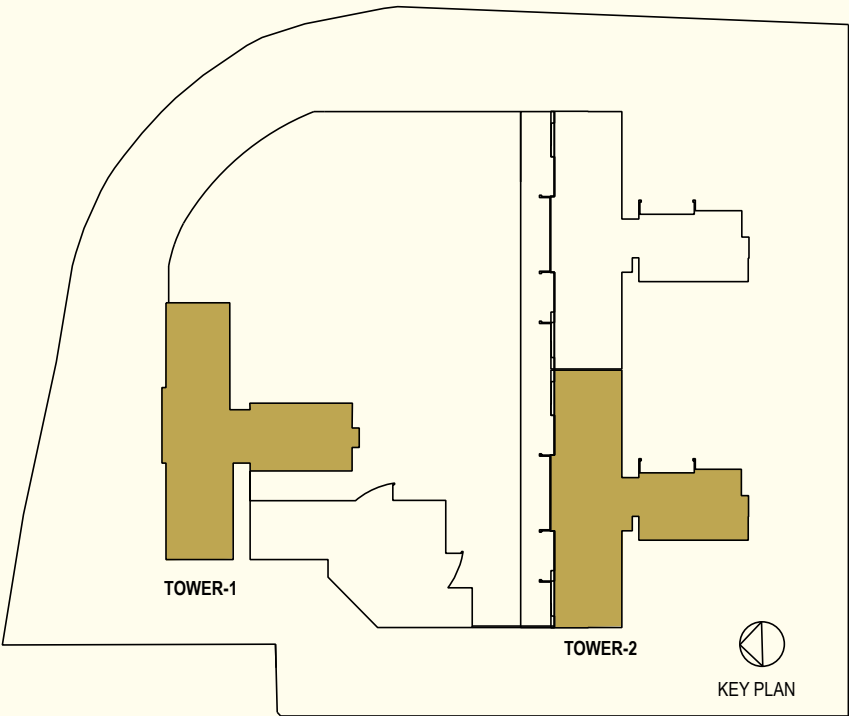

TYPICAL FLOOR PLAN

5TH, 8TH, 11TH, 14TH, 17TH, 20TH, 23RD, 26TH & 29TH FLOORS



FLAT TYPE - A		
SL. NO.	SPACE MARKING	ROOM DIMENSION (IN FPS)
1	PUJA	4'-10" X 5'-6"
2	MASTER BEDROOM	17'-0" X 12'-0"
3	MASTER TOILET	8'-0" X 6'-8"
4	DRESS	5'-8" X 7'-3"
5	BEDROOM-1	14'-0" X 11'-10"
6	TOILET-1	8'-10" X 5'-6"
7	BEDROOM-2	11'-10" X 11'-10"
8	TOILET-2	9'-2" X 7'-3"
9	BEDROOM-3	14'-0" X 11'-10"
10	DINING	14'-6" X 11'-4"
11	KITCHEN	12'-7" X 7'-10"
12	UTILITY / WASH	3'-6" X 6'-9"
13	DRAWING ROOM	19'-0" X 17'-3"
14	BALCONY	4'-0" X 12'-0"
15	OPEN TERRACE AREA - 108 SQ.FT.	

FLAT TYPE - B		
SL. NO.	SPACE MARKING	ROOM DIMENSION (IN FPS)
1	PUJA	5'-0" X 8'-0"
2	MASTER BEDROOM	13'-8" X 11'-3"
3	MASTER TOILET	8'-10" X 5'-5"
4	DRESS	4'-10" X 6'-0"
5	BEDROOM-1	14'-0" X 9'-7"
6	TOILET-1	9'-9" X 5'-7"
7	BEDROOM-2	11'-10" X 11'-10"
8	BEDROOM-3	14'-0" X 11'-10"
9	TOILET-2	9'-2" X 7'-3"
10	DINING	16'-6" X 11'-4"
11	KITCHEN	12'-2" X 7'-10"
12	UTILITY / WASH	3'-6" X 6'-9"
13	DRAWING ROOM	19'-0" X 17'-3"
14	POWDER TOILET	4'-0" X 5'-7"
15	BALCONY	4'-0" X 12'-0"
16	OPEN TERRACE AREA - 108 SQ.FT.	

FLAT TYPE - C		
SL. NO.	SPACE MARKING	ROOM DIMENSION (IN FPS)
1	PUJA	6'-6" X 5'-0"
2	MASTER BEDROOM	16'-3" X 14'-0"
3	MASTER TOILET	9'-9" X 5'-10"
4	DRESS	6'-0" X 5'-10"
5	BEDROOM-1	11'-3" X 14'-0"
6	TOILET-1	6'-2" X 9'-6"
7	BEDROOM-2	12'-0" X 14'-0"
8	TOILET-2	5'-4" X 8'-9"
9	BEDROOM-3	12'-0" X 14'-0"
10	TOILET-3	5'-2" X 8'-9"
11	DINING	11'-4" X 14'-5"
12	KITCHEN	8'-0" X 12'-2"
13	UTILITY / WASH	3'-6" X 6'-9"
14	DRAWING ROOM	17'-0" X 18'-0"
15	BALCONY	4'-0" X 12'-0"
16	OPEN TERRACE AREA - 104 SQ.FT.	

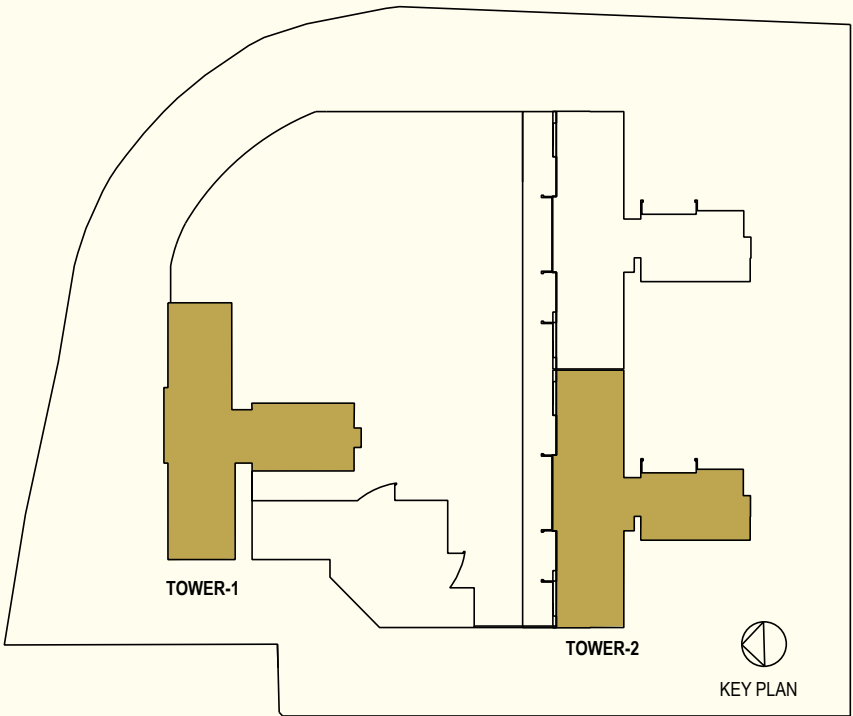

TYPICAL FLOOR PLAN

30TH FLOOR



FLAT TYPE - A		
SL. NO.	SPACE MARKING	ROOM DIMENSION (IN FPS)
1	PUJA	5'-3" X 5'-6"
2	MASTER BEDROOM	17'-0" X 12'-0"
3	MASTER TOILET	8'-0" X 6'-3"
4	POWER TOILET	5'-8" X 7'-3"
5	BEDROOM-1	14'-0" X 12'-0"
6	TOILET-1	8'-10" X 5'-6"
7	BEDROOM-2	14'-0" X 9'-5"
8	TOILET-2	9'-6" X 6'-5"
9	BEDROOM-3	14'-0" X 11'-10"
10	DINING	14'-6" X 11'-4"
11	KITCHEN	12'-7" X 7'-10"
12	UTILITY / WASH	3'-6" X 6'-9"
13	DRAWING ROOM	19'-0" X 17'-3"
14	OPEN TERRACE AREA - 218 SQ.FT.	

FLAT TYPE - B		
SL. NO.	SPACE MARKING	ROOM DIMENSION (IN FPS)
1	PUJA	5'-0" X 8'-0"
2	MASTER BEDROOM	13'-8" X 11'-3"
3	MASTER TOILET	8'-10" X 5'-5"
4	DRESS	4'-10" X 6'-0"
5	BEDROOM-1	14'-0" X 9'-7"
6	TOILET-1	9'-9" X 5'-7"
7	BEDROOM-2	11'-10" X 11'-10"
8	BEDROOM-3	14'-0" X 11'-10"
9	TOILET-2	9'-2" X 7'-3"
10	DINING	16'-6" X 11'-4"
11	KITCHEN	12'-2" X 7'-10"
12	UTILITY / WASH	3'-6" X 6'-9"
13	DRAWING ROOM	19'-0" X 17'-3"
14	POWDER TOILET	4'-0" X 5'-7"
15	OPEN TERRACE AREA - 198 SQ.FT.	

FLAT TYPE - C (DUPLEX - LOWER LEVEL)		
SL. NO.	SPACE MARKING	ROOM DIMENSION (IN FPS)
1	PUJA	6'-6" X 5'-0"
2	MASTER BEDROOM	16'-3" X 14'-0"
3	MASTER TOILET	9'-9" X 5'-10"
4	DRESS	6'-0" X 5'-10"
5	BEDROOM-1	11'-3" X 14'-0"
6	TOILET-1	6'-2" X 9'-6"
7	TOILET-2	5'-7" X 8'-9"
8	DINING	11'-4" X 14'-5"
9	KITCHEN	8'-0" X 11'-9"
10	DRAWING ROOM	17'-0" X 18'-0"
11	UTILITY / WASH	3'-6" X 6'-9"
12	OPEN TERRACE AREA - 493 SQ.FT.	

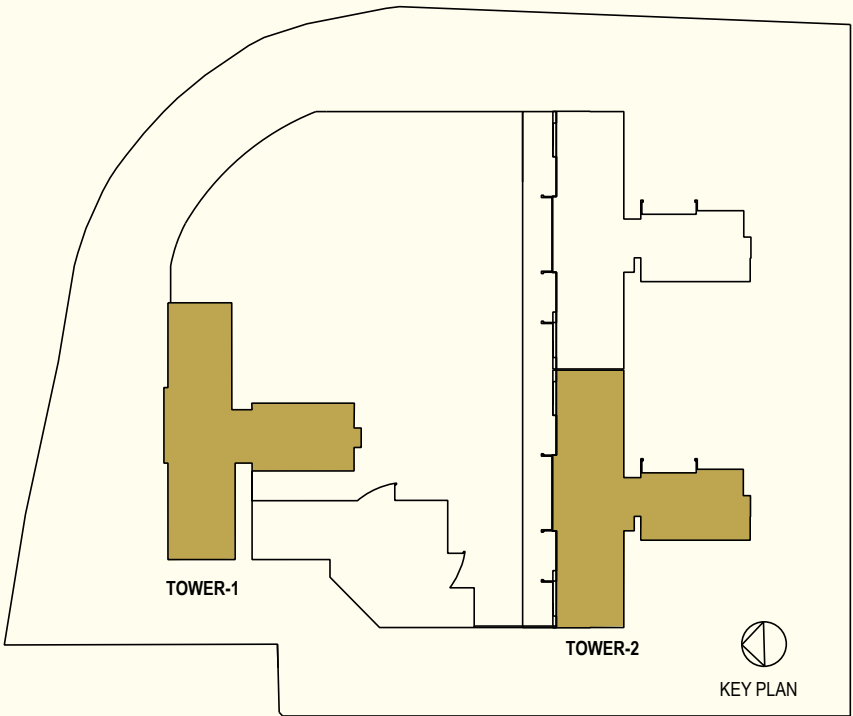

TYPICAL FLOOR PLAN

31ST FLOOR



FLAT TYPE - A		
SL. NO.	SPACE MARKING	ROOM DIMENSION (IN FPS)
1	MASTER BEDROOM	17'-0" X 12'-0"
2	MASTER TOILET	8'-0" X 6'-8"
3	DRESS	5'-8" X 7'-3"
4	BEDROOM-1	14'-0" X 12'-0"
5	TOILET-1	9'-6" X 5'-6"
6	BEDROOM-2	14'-0" X 9'-5"
7	TOILET-2	9'-6" X 6'-5"
8	DRAWING ROOM	19'-0" X 11'-7"
9	DINING	19'-0" X 12'-4"
10	KITCHEN	11'-8" X 7'-10"
11	BALCONY	4'-0" X 12'-0"
12	OPEN TERRACE AREA - 420 SQ.FT.	

FLAT TYPE - B		
SL. NO.	SPACE MARKING	ROOM DIMENSION (IN FPS)
1	PUJA	5'-0" X 8'-0"
2	MASTER BEDROOM	13'-8" X 11'-3"
3	MASTER TOILET	8'-10" X 5'-5"
4	DRESS	4'-10" X 6'-0"
5	BEDROOM-1	15'-10" X 12'-0"
6	TOILET-1	9'-2" X 7'-3"
7	BEDROOM-2	15'-3" X 9'-7"
8	DINING	16'-6" X 11'-4"
9	KITCHEN	12'-2" X 7'-10"
10	DRAWING ROOM	19'-0" X 17'-3"
11	OPEN TERRACE AREA - 447 SQ.FT.	

FLAT TYPE - C (DUPEX - UPPER LEVEL)		
SL. NO.	SPACE MARKING	ROOM DIMENSION (IN FPS)
1	PUJA	6'-0" X 14'-6"
2	LIVING ROOM	11'-4" X 14'-6"
3	MASTER BEDROOM-2	16'-3" X 12'-9"
4	MASTER TOILET	8'-0" X 5'-10"
5	DRESS	4'-0" X 6'-3"
6	BEDROOM-2	11'-3" X 14'-0"
7	TOILET-3	6'-2" X 9'-6"
8	OPEN TERRACE AREA - 301 SQ.FT.	

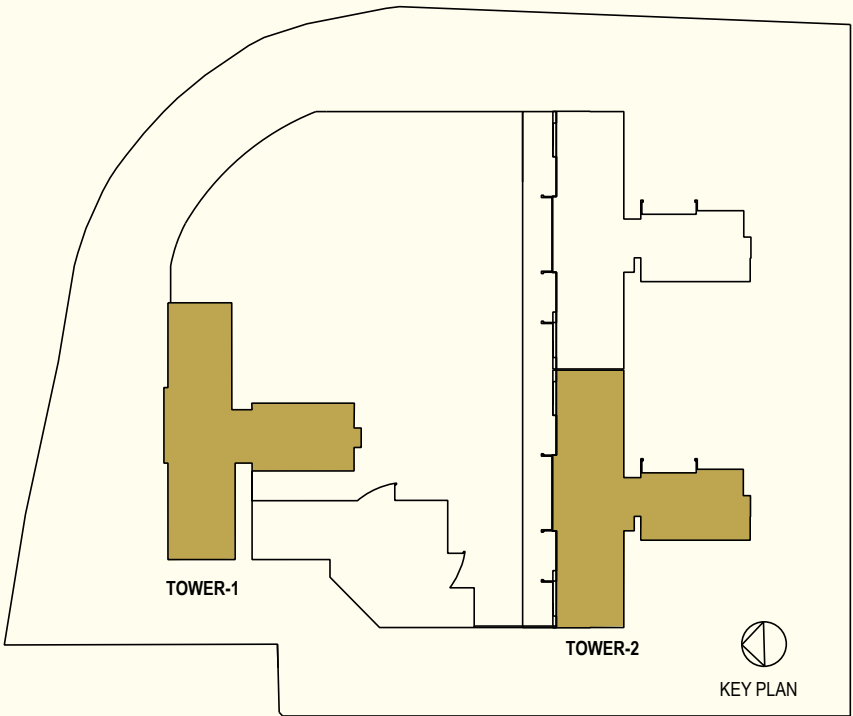

APARTMENT AND TOWER SPECIFICATIONS



SL. NO.	PARTICULARS	SPECIFICATIONS OF THE BARE FLAT
1	FOUNDATION	R.C. foundation resting on cast-in-situ reinforced concrete bored piles complying with IS-2911
2	SUPERSTRUCTURE	Reinforced concrete framed structure using minimum M25 grade concrete complying with IS-456/IS 1893/ IS 13920 and Fe 500 Steel reinforcement complying with IS-1786
		RCC structure designed for the highest seismic consideration against zone III or as stipulated by code, ensuring better safety
3	WALLS	
	(a) External Walls	Common Clay bricks/Fly Ash bricks / or reinforced concrete walls
	(b) Internal Walls	Common Clay bricks/Fly Ash bricks / and / or reinforced concrete walls
4	ULTIMATE ROOF	Reinforced concrete roof with appropriate waterproofing and an under deck insulation system to the top floor flat to protect against heat
5	FINISHES CEILING - COMMON AREAS	Standard POP / Gypsum Board with or without drops and finished in enamel/acrylic paint
	(a) Lift lobby	
	(b) Car Park Areas	Cement & Sand Plaster finished in Cement Paint
	(c) Staircases, M & E services rooms/ shaft and utilities	Cement & Sand Plaster with neat POP punning. Staircases will be finished with two coats of enamel/acrylic Paint
6	FINISHES WALLS - COMMON AREAS	
(i)	WALL - EXTERNAL	Cement & Sand Plaster with cement paint and / or texture finish/ or Weather shield paint finish with glazing and/or dry cladding as per architectural drawings at designated areas
(ii)	WALL- INTERNAL	Cement & Sand Plaster with neat POP punning finished in two coats of enamel and/or acrylic Paint
	(a) Corridors, Staircases, Landing and other areas	
	(b) Car Park Areas	Cement & Sand Plaster finished in Cement Paint
	(c) Ground Floor Entrance Lobby	Cement & Sand Plaster finished in combination of neat POP punning, texture paint and Marble or Granite cladding at designated areas
7	FLOOR- COMMON AREAS	Finished in polished Green Marble or Kota stone or Pre-moulded tile
	(a) Staircases including landings and corridors at car park level, and typical floors	
	(b) Lift lobby/ Vestibule	Quality imported marble with matching skirting with or without inlay works at designated areas
	(c) Other common areas	Screed concrete
8	WINDOWS	Standard section of Anodized/Powder Coated Aluminium and/or UPVC casement with clear toughened double glazed glass inserts with sound attenuation arrangement with matching fittings and will be provided with guard bars
9	LIGHTNING PROTECTION	Lightning Protection- In compliance with IS 2309
10	DRIVEWAY	(a) Reinforced concrete slab with hardener
		(b) Stone and/or paver block and/or bituminous compound
		(c) Duly finished greeneries at designated places around driveway
11	FIRE SUPPRESSION & DETECTION	(a) Provision of adequate fire fighting system with wet risers and fire sprinklers connected to Fire Reservoir and fire pumps.
		(b) Evacuation points and refuge platforms for human safety as per regulation
		(c) Smoke detectors and fire sprinklers in common areas and flats
		(d) Both way Public Address system at all floors
12	FINISHES CEILING - APARTMENT UNITS	Bare Concrete
	(a) Living, Dining, Entrance Foyer, Bedrooms, Study, Store and other areas	
	(b) Kitchen, Bathrooms, W.C	Bare Concrete
	(c) Servant Quarter	Cement & Sand Plaster with neat POP punning

SL. NO.	PARTICULARS	SPECIFICATIONS OF THE BARE FLAT
13	FINISHES -WALLS APARTMENT UNITS	Bare Concrete/ Brick work finished in sand & cement plaster
	(a) Living, Dining, Bedrooms, Study, Entrance Foyer, Store and other areas	
	(b) Kitchen, Bathrooms, W.C	Bare Concrete/ Brick work finished in sand & cement plaster
	(c) Servants Quarter	Cement & Sand Plaster with neat POP punning
14	FLOOR- FOR APARTMENT UNITS	Bare
	(a) Entrance Foyer, Living and dining	
	(b) Bedrooms, Study and internal staircase	Bare
	(c) Master Bedroom	Bare
	(d) Bathrooms, W.C	Bare
	(e) Kitchen	Bare
	(f) Store / Servant Quarter	Quality Indian marble flooring and/or ceramic tile flooring
15	FITTED DOORS	Main Door- Salwood door frame with flush shutters having spirit polish teak veneer finished on both faces along with Door Lock, Handle and Magic Eye.
16	SANITARY WARES	Not Provided
17	CP FITTINGS	Soil and Waste Water piping will be provided. Separate domestic and flushing Water Piping will be provided. Further installation of CP & sanitary fixtures will be within the scope of the customer.
18	PIPING SYSTEM	Dual Piping system provided
19	KITCHEN	(a) Kitchen to be finished by the customer. Piping from the cooking Gas Bank will be provided up to the metering point; further reticulation within the kitchen is in customer's scope (b) Dual source of water supply provided within shaft upto the kitchen entry of the said unit;further reticulation within the kitchen is in Customer's scope
20	TV/ TELEPHONE POINTS	Compatible wiring which can be hooked up to a cable television network will be provided in a junction box at the entry of the unit.
21	WATER PROOFING	Water proofing to floor(s) of the kitchen, Bathrooms, W.C., Balcony, Planter Boxes, Terraces, Landscape Deck, Ultimate Roof, Pool and Open terraces will be provided
22	AIR CONDITIONING	In the scope of the customer.
23	ELECTRICAL WIRING & FITTINGS	(a) Power will be provided at the DB of Flat entry. Internal reticulation will be within the scope of customer. (b) Electrical call bell at main entrance door. (c) Provision will be kept at the entry of the flat for Connection of Intercom/EPAX with the Reception, Security and all other apartments of the complex.
24	POWER & BACKUP	(a) 24 x 7 Power
		(b) Through Generator power will be provided in the said Unit during power failure for lighting and other domestic purposes to the extent of 1 (one) Watt per Square foot of the built-up area of the said Unit controlled by electric circuit breaker. (c) Instant change over between mains and auto synchronized DG set.
25	SECURITY	(a) CCTV monitoring for common areas.
		(b) Compatible wiring for Panic Alarm system will be terminated at a junction box at flat entry. Further reticulation will be within the scope of customer. (c) Video door phone will be provided at the entrance of the flat.
26	ENTRY & EXIT	Gates will be enabled with an RFID based access control system for ease of access In and Out of the Complex.

AREA STATEMENT



MAHADEVA

FLOOR	FLAT TYPE	CARPET AREA OF FLAT (in Sq. ft)	BUILT-UP AREA (in Sq.ft)	AREA OF ATTACHED SKY BALCONY (in Sq.ft)	MAINTENANCE CHARGEABLE AREA (in Sq. ft)
2nd	MA	1733	2108	0	2838
	MB	1703	2118	0	2851
	MC	1877	2363	0	3181
Typical Floor Area (3rd, 6th, 9th, 12th, 15th, 18th, 21st, 24th & 27th)	MA	1733	2108	168	2922
	MB	1703	2116	145	2921
	MC	1877	2363	115	3239
Typical Floor Plan (4th, 7th, 10th, 13th, 16th, 19th, 22nd, 25th & 28th)	MA	1733	2108	107	2891
	MB	1703	2116	107	2902
	MC	1877	2363	165	3264
Typical Floor Plan (5th, 8th, 11th, 14th, 17th, 20th, 23rd, 26th & 29th)	MA	1733	2108	108	2892
	MB	1703	2116	108	2903
	MC	1877	2363	104	3233
30th.	MA	1729	2059	218	2881
	MB	1703	2038	198	2843
	MC	1546	1945	493	2865
31st.	MA	1469	1746	420	2560
	MB	1375	1698	447	2509
	MC	998	1495	301	2163

SADASHIVA

FLOOR	FLAT TYPE	CARPET AREA OF FLAT (in Sq. Ft)	BUILT-UP AREA (in Sq.ft)	AREA OF ATTACHED SKY BALCONY (in Sq.ft)	MAINTENANCE CHARGEABLE AREA (in Sq. ft)
2nd	SA	1733	2159	0	2906
	SB	1703	2207	0	2971
					0
Typical Floor Area (3rd, 6th, 9th, 12th, 15th, 18th, 21st, 24th & 27th)	SA	1733	2108	168	2922
	SB	1703	2116	145	2921
	SC	1877	2363	115	3239
Typical Floor Plan (4th, 7th, 10th, 13th, 16th, 19th, 22nd, 25th & 28th)	SA	1733	2108	107	2891
	SB	1703	2116	107	2902
	SC	1877	2363	165	3264
Typical Floor Plan (5th, 8th, 11th, 14th, 17th, 20th, 23rd, 26th & 29th)	SA	1733	2108	108	2892
	SB	1703	2116	108	2903
	SC	1877	2363	104	3233
30th.	SA	1729	2059	218	2881
	SB	1703	2038	198	2843
	SC	1546	1945	493	2865
31st.	SA	1469	1746	420	2560
	SB	1375	1698	447	2509
	SC	998	1495	301	2163

भारतमा सहितं समामि

Project Address:
P 1/3 CIT Road, Scheme VII-M, Off Kankurgachi,
Kolkata- 700054.

Call: 98 8881 8881

Disclaimer: This is not a legal tender. It is an information kit. It contains concept drawings which may undergo sanctionable changes at the discretion of the developer.